

# Technical Information

01.96

## Servicing Instructions for STIHL 036 QS - "Quickstop Super" - Series 1125

Inspection, maintenance and repair work may only be performed by properly trained and authorized personnel.

### 1. Checking operation of chain brake (with bar and chain)

#### 1.1 Activate interlock lever

- Open throttle wide.
- Release rear handle.
- Chain must come to a standstill within fractions of a second.

#### 1.2 Activate hand guard

- Open throttle wide.
- Activate hand guard.
- Chain must come to a standstill within fractions of a second.

The following conditions may occur:

- A** Brake cannot be activated
- B** Brake cannot be activated by interlock lever
- C** Brake cannot be activated by hand guard
- D** Brake cannot be activated by interlock lever **or** hand guard

### 2. Disassembly

#### 2.1 Interlock lever

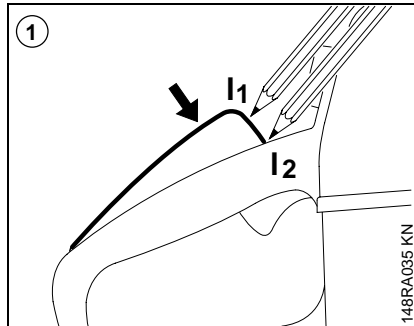

- Check free travel as follows: Press down interlock lever until definite resistance is felt - mark **I1**. Let go of interlock lever - mark **I2**. If the distance between **I1** and **I2** is less than 6 mm (0.24"), the brake cable is stretched.

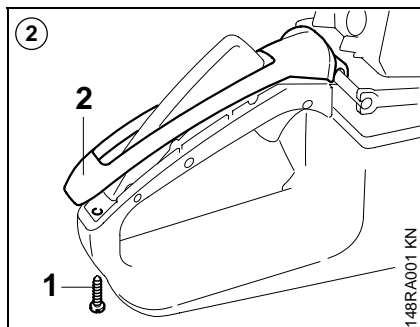

- Remove carburetor box cover and air filter.
- Take self-tapping screw (1) out of tank housing.
- Lift away the handle molding (2).

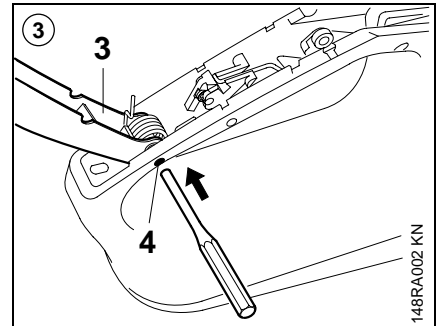

- Use a 3.0 mm (0.12") pin punch to drive the needle roller (4) out of the interlock lever (3).

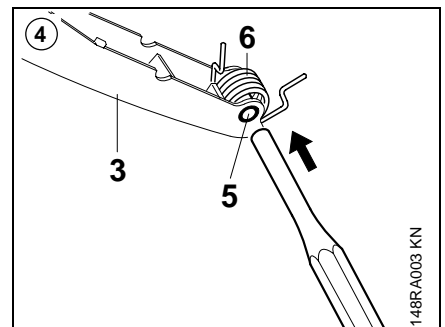

- Use a 4.5 mm (0.18") pin punch to drive the bushing (5) out of the interlock lever (3).
- Remove the torsion spring (6).

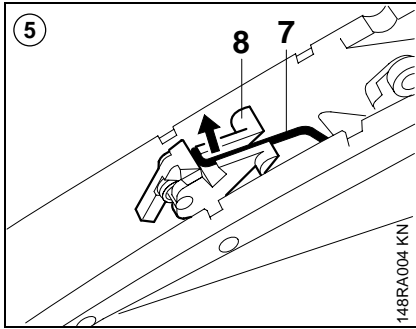

- Disconnect brake cable (7) from the trip lever (8).

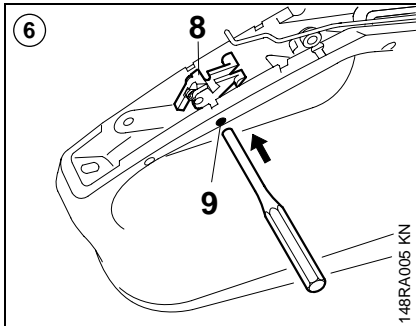

- Use a 4.0 mm (0.16") pin punch to drive the needle roller (9) out of the trip lever (8).
- Remove the trip lever.

**Note:**

- Clean all parts with STIHL universal cleaner.
- Damaged parts\* must be replaced.

## 2.2 Exposing chain brake

- Remove chain sprocket cover and side plate.

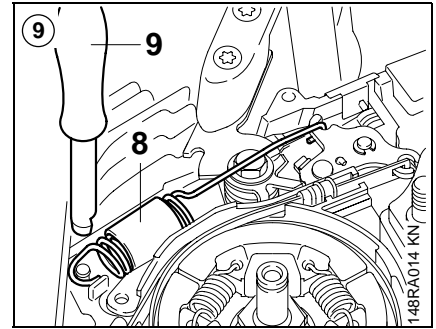

- Use assembly tube (9) to disconnect the brake spring (8).

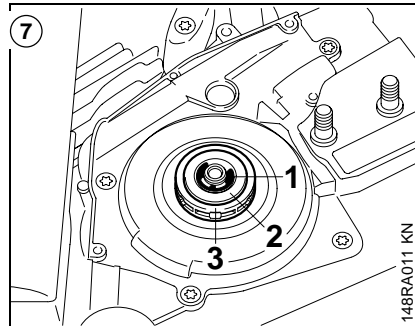

- Remove E-clip (1).
- Remove washer (2) and chain sprocket (3).

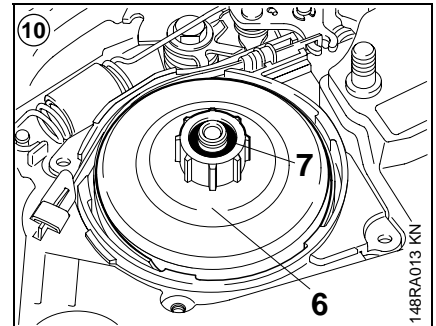

- Remove the clutch drum (6) and needle cage (7).

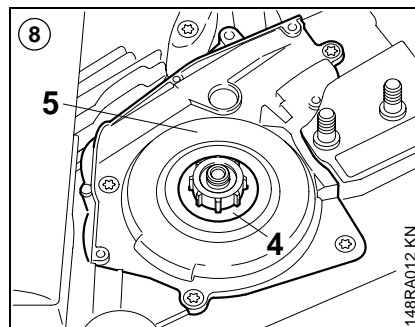

- Take off the washer (4) and unscrew the cover (5).

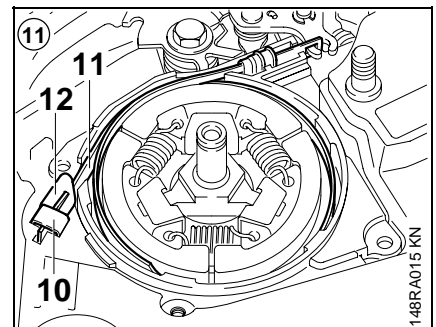

- Remove the clip (10).
- Take out the brake band (11) together with the support plate (12).

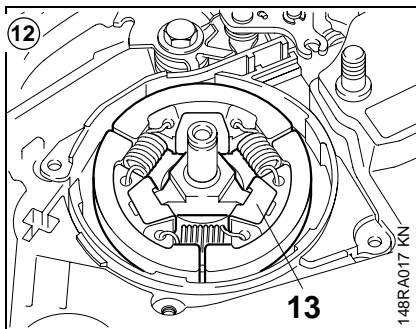

- Remove the clutch (13) (shroud, spark plug).

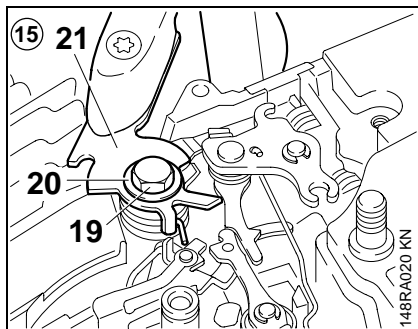

- Take the hex. head screw (19) out of the crankcase. Remove washer (20) from hand guard lever (21).
- Take screw assembly out of fan housing. Remove the hand guard.

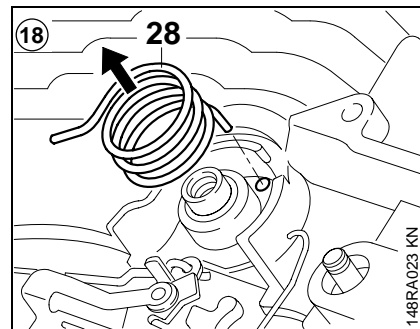

- Remove torsion spring (28).

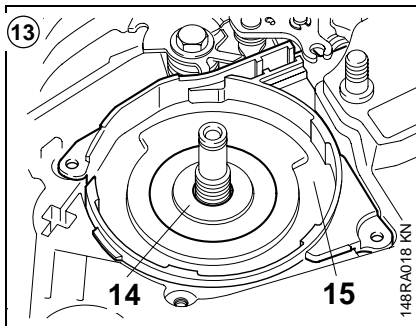

- Take away the cover washer (14) and cover (15).

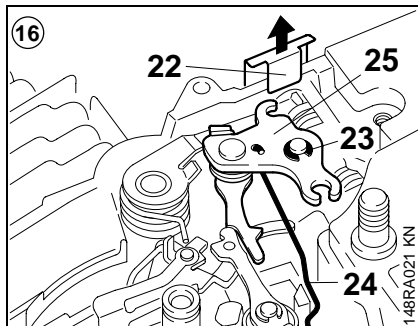

- Remove the stop plate (22).
- Remove the E-clip (23). Pull off the brake lever (25) and disconnect the rod (24).

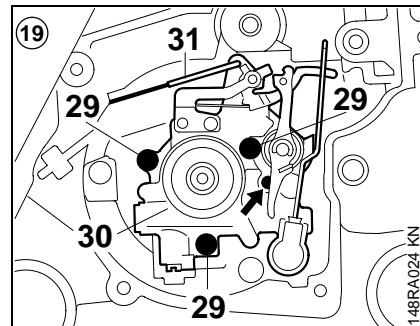

- Insert pin or suitable tool in hole (see arrow) to secure tension lever in position.
- Take spline screws (29) out of the oil pump housing (30). Pull the oil pump housing away and disconnect the brake cable (31).

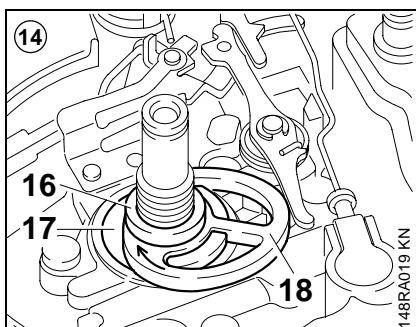

- Remove the spacer ring (16), worm gear (17) and cam (18).

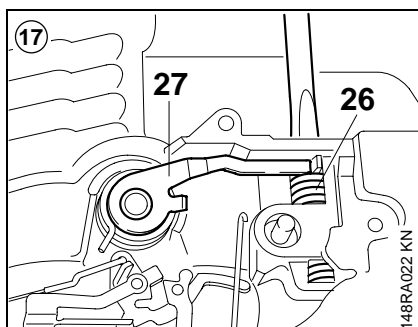

- Press the compression spring (26) downwards and remove the locating lever (27) at the same time.

**Note:**

- Clean all parts with STIHL universal cleaner.
- Damaged parts\* must be replaced.
- Clean pump seat in crankcase.

\* use only original STIHL replacement parts as per the latest parts list

## 2.3 Oil pump housing

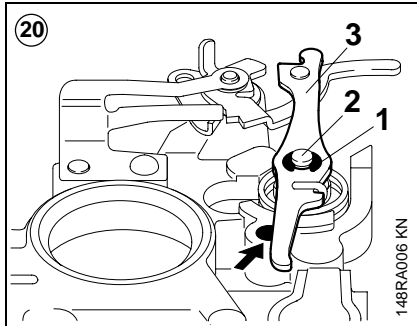

- Relieve tension lever.
- Ease the E-clip (1) off the stud (2).
- Take the tension lever (3) off the stud.

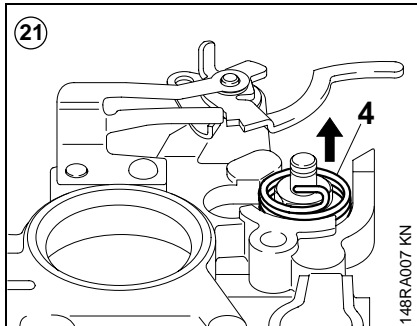

- Remove the torsion spring (4).

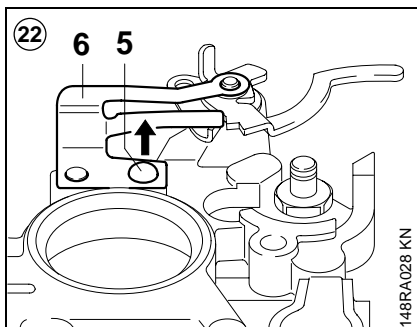

- Use 3.0 mm (0.12") pin punch to drive round head grooved pin (5) out of the oil pump housing.
- Remove the flat spring (6).

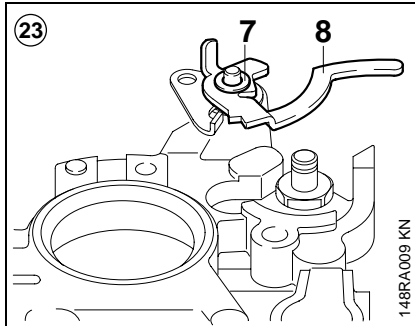

- Pull off the washer (7) and retaining lever (8).

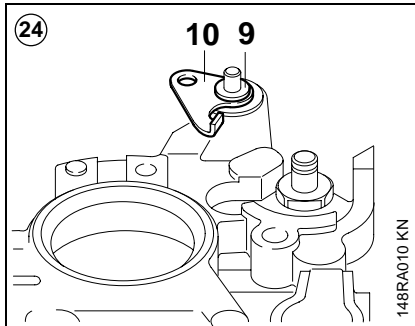

- Remove washer (9) and trip plate (10).

### Note:

- Clean all parts with STIHL universal cleaner.
- Damaged parts\* must be replaced.

## 3. Assembly

Lubricate all moving parts (see arrows in illustrations under 4) with oil or grease.

### 3.1 Interlock lever

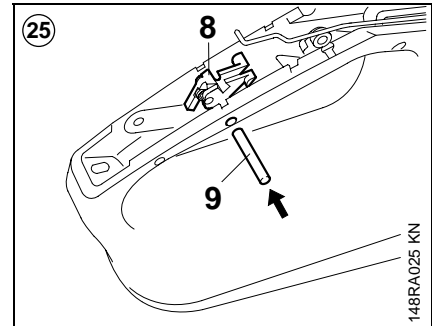

- Drive needle roller (9) into trip lever (8).

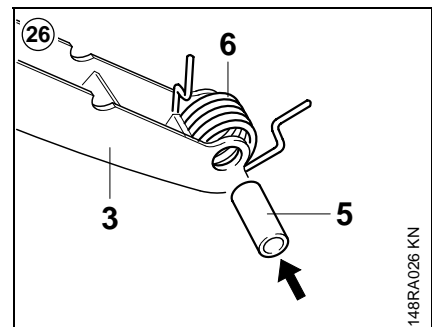

- Push bushing (5) through one side of the interlock lever (3) and torsion spring (6) drive it into the interlock lever.

\* use only original STIHL replacement parts as per the latest parts list

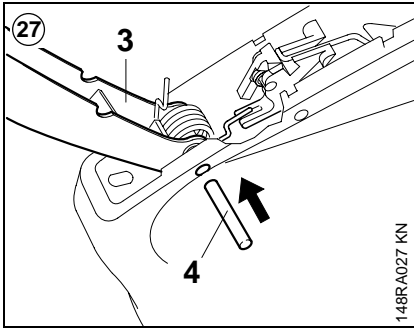

- Drive needle roller (4) into the interlock lever (3) - right-hand end of spring must locate in trip lever groove.

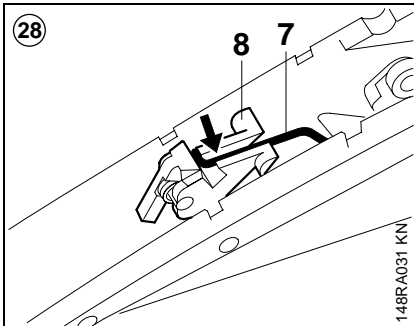

- Position brake cable (7) in trip lever (8).

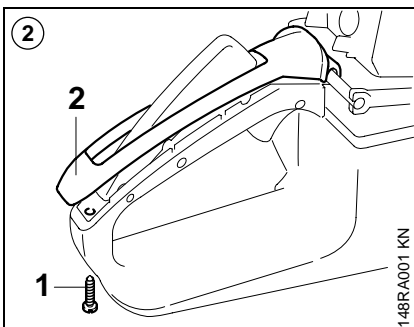

- Fit handle molding (2) and secure to tank housing with self-tapping screw (1).
- Install the air filter.

### 3.2 Oil pump housing

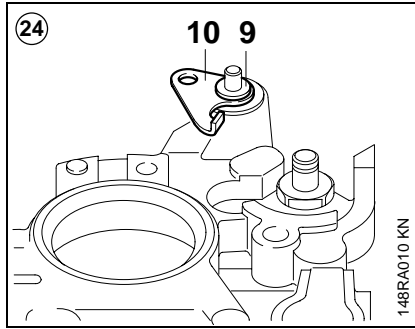

- Fit trip plate (10) and washer (9) on oil pump housing.

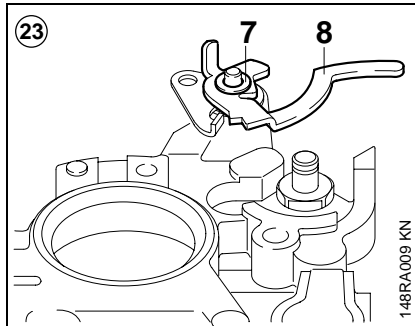

- Fit retaining lever (8) and washer (7) on oil pump housing.

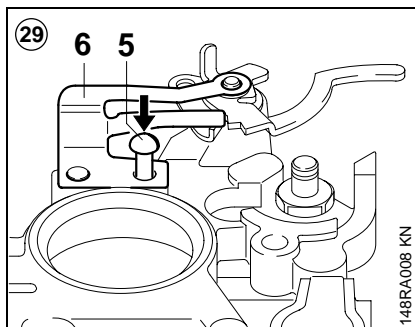

- Fit the flat spring (6).
- Drive round head grooved pin (5) into oil pump housing.

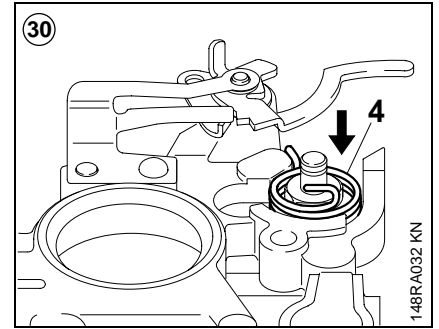

- Fit the torsion spring (4).

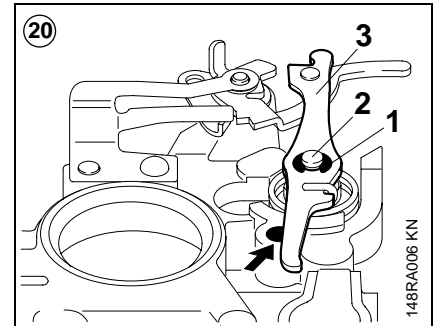

- Slip tension lever (3) over stud (2) and secure with the E-clip (1).
- Use suitable tool to secure tension lever in position (see arrow).

### 3.3 Assembling chain brake

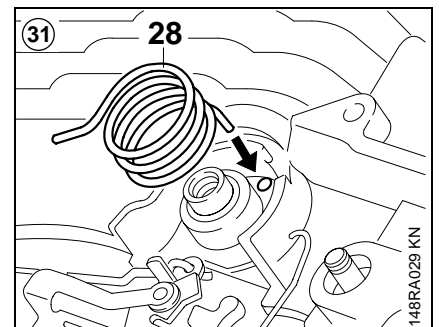

- Place torsion spring (28) in crankcase.

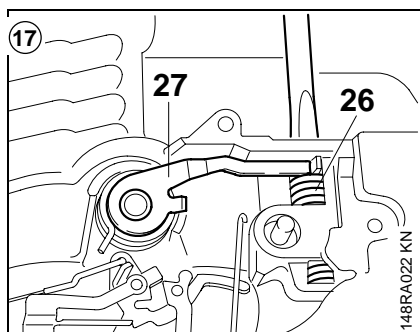

- Hook locating lever (27) on to torsion spring.
- Press compression spring (26) downwards and allow locating lever (27) to engage.

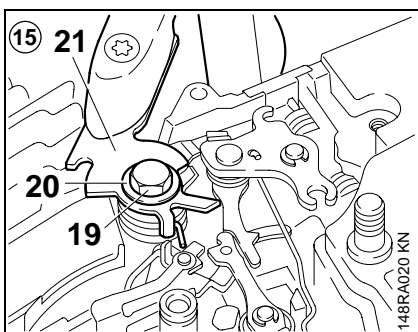

- Fit hand guard lever (21).
- Fit washer (20) and screw hex. head screw (19) into the crank-case.

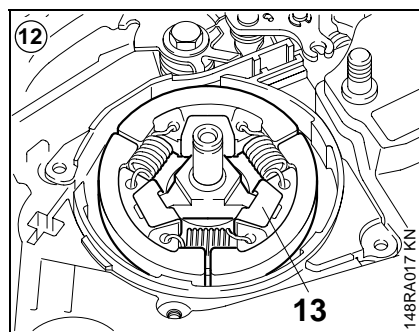

- Install the clutch (13).

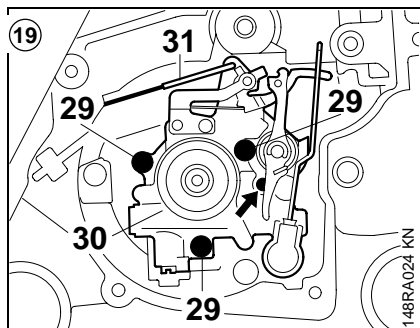

- Attach brake cable (31) to brake lever
- Fit oil pump housing (30) and secure with the spline screws (29).
- Place rod in the valve.

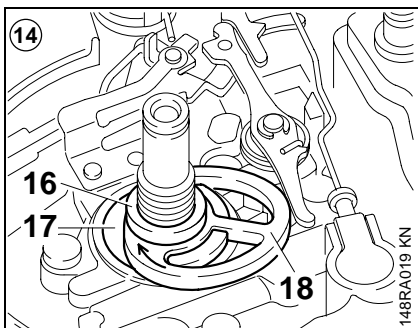

- Fit worm gear (17), cam (18) - arrow must point up - and spacer ring (16) on the crankshaft.

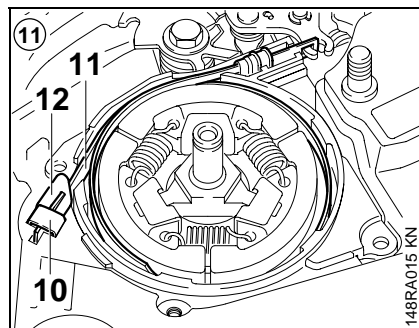

- Fit brake band (11) with support plate (12) and secure with clip (10).

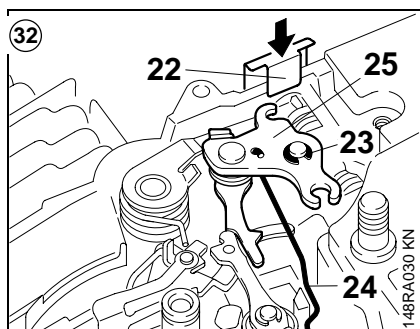

- Attach rod (24) to brake lever (25) - fit E-clip (23).
- Push stop plate (22) into position.

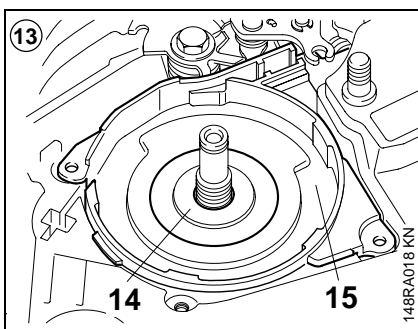

- Fit cover (15) and cover washer (14).

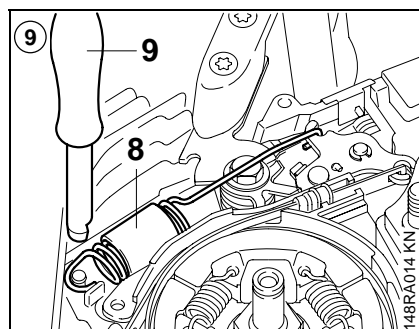

- Use assembly tube (9) to attach brake spring (8).

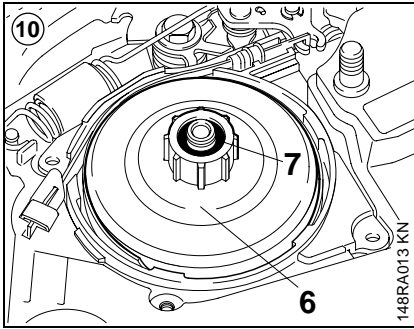

- Fit needle cage (7) and clutch drum (6).

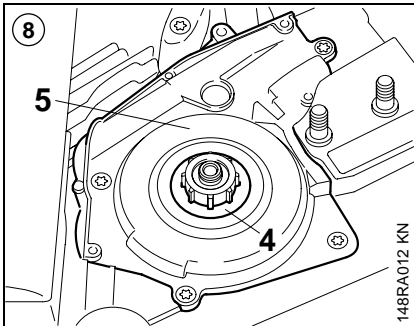

- Fit the cover (5) and washer (4).

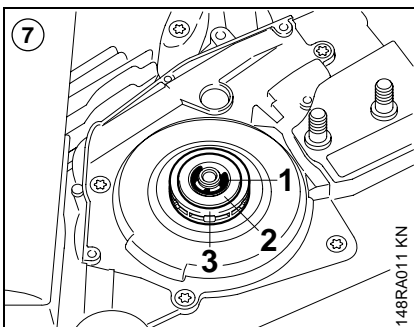

- Fit the chain sprocket (3) and washer (2). Secure with E-clip (1).
- Fit the side plate and chain sprocket cover.

#### 4. Maintenance

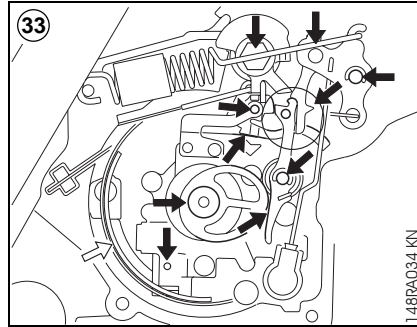

- Grease with Mobilplex 0781 120 1111
- ⇒ Lubricate with chain oil\* (outside diameter of clutch drum).

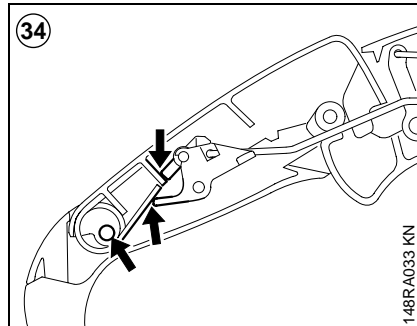

- Grease with Mobilplex 0781 120 1111

\* Important: Owners who wish to run a biological chain oil should use only STIHL Bioplus.

## 5. Troubleshooting chart

Fault	Cause	Remedy	Disassembly / Assembly Figures ① ② ③ etc.
<b>A:</b> Brake cannot be activated	<ul style="list-style-type: none"> <li>free travel &lt; 6 mm (0.24"); brake cable stretched</li> </ul>	Replace brake cable	1,2,5,7,8,9,10,11,12,13,19 / 33,19,13,12,11,9,10,8,7, 34,28,2
	<ul style="list-style-type: none"> <li>All moving parts on oil pump housing smeared with pitch</li> </ul>	Disassemble, clean and service oil pump housing (see 4)	7 -14,16,19,20,21,22,23,24 / 33,24,23,29,30,20,19,32,14, 13,12,11,9,10,8,7
	<ul style="list-style-type: none"> <li>Rivet on tension lever worn (play &gt; 0.5 mm)</li> </ul>	Fit new tension lever	7-14,16,19,20 / 33,20,19,14,32,13,12,11,9, 10,8,7
	<ul style="list-style-type: none"> <li>Pitch between inside of cover and clutch drum</li> </ul>	Disassemble, clean and service cover and clutch drum (see 4)	7-13 / 33,13,12,11,9,10,8,7
<b>B:</b> Brake cannot be activated by interlock lever	<ul style="list-style-type: none"> <li>All moving parts on oil pump housing smeared with pitch</li> </ul>	Disassemble, clean and service oil pump housing (see 4)	7 -14,16,19,20,21,22,23,24 / 33,24,23,29,30,20,19,32,14, 13,12,11,9,10,8,7
<b>C:</b> Brake cannot be activated by hand guard	<ul style="list-style-type: none"> <li>Lug on retaining lever broken</li> </ul>	Disassemble oil pump housing - Replace retaining lever	7 -14,16,19,20,21,22,23,24 / 33,24,23,29,30,20,19,32,14, 13,12,11,9,10,8,7
	<ul style="list-style-type: none"> <li>Hand guard mounting loose</li> </ul>	Tighten hex. head screw <sup>1)</sup> (crankcase) to 6.5 Nm Retighten spline screw IS-M 5x30 (2x) <sup>1)</sup>	7,8,9,15 / 33,15,9,8,7
<b>D:</b> Brake cannot be activated by interlock lever <b>or</b> by hand guard	<ul style="list-style-type: none"> <li>Brake band broken</li> </ul>	Fit new brake band - lubricate clutch drum (see 4)	7-11 / 33,11,9,10,8,7

1) Screw must be secured with Loctite 648 adhesive